

# Hubitools

## INNOVATIVE TOOL EXPERTS







With over 40 years experience in the distribution of innovative tools, Hubitools is your key partner in the automotive and industrial repair sector.

Since 2016, we've been developing our own Hubitools Design range, featuring unique, patented tools designed to help professionals solve common problems in modern vehicles.

In addition to our patented products, we have long been the exclusive European distributor for international manufacturers of quality tools.

We offer our partners a complete service from A to Z: multilingual marketing packages, technical training in our video studio, after-sales service and private-label customization.



## NEW PRODUCT HIGHLIGHTS

**TURBO JET  
AIR BLOWERS**



**P.31**

**ELECTRONIC  
BRAKE PRO BLEEDER**



**P.5**

**UNIVERSAL PRESSURE TESTER 2.0  
WITH WIRELESS MODULE**



**P.6**

**VIDEOSCOPIES 3,9 MM**



**P.11**

**HYBRID & EV TEST LEAD KIT**

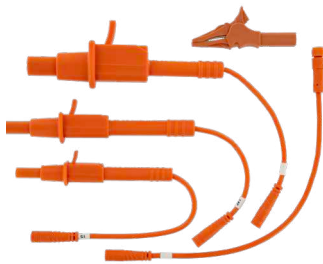

**P.16**

**ARTICULATED MCPHERSON LIFTING TOOL (500 KG)**



**P.23**

**DRIVE SHAFT DISASSEMBLY LEVER**



**P.24**

**MAGNETIC ADJUSTABLE TOOL HOLDER**



**P.25**

**2-IN-1 HOT AIR & HOT IRON  
PLASTIC REPAIR STATION**



**P.28**

**SMART & MOBILE OIL BAR DISPENSER**



**P.32**

## AUTOMATIC BRAKE BLEEDER 12V

**HU11006N**

- Compatible with ABS/ESP systems
- 12v powering with reverse polarity warning
- Stainless steel body
- Electrical pump (0 to 3,5 Bar) with automatic power off valve
- Regulator from 0 to 3,5 Bar
- 5L reservoir with visible (min) level indication
- Auto power-OFF when min level is reached
- Large reservoir opening for easy cleaning
- 12V power cable with jack (L: 4m)
- For brake fluid with quick coupling system
- Delivered with fluid refill reservoir with chain and universal screw-on adaptor (compatible with 85% of vehicle fleet)
- Optional: 110-230V AC to 12V DC power supply (HU11033).



## MASTER CYLINDER ADAPTER SET

**HU11004**

- 10 dedicated caps
- 1 universal cap
- 190° adapter
- 1 syringe



**NEW**

## BRAKE BLEEDING RATCHETING WRENCH

**HU11009**

- Enables a clean brake bleeding job without removing the wheels of the vehicle
- Patented brake bleeding 2-way ratcheting wrench with special short and long sockets – size metric 7, 8, 9, 10, 11, 12.
- Includes a high-quality silicon hose.

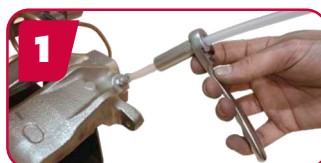

**NEW**

## UNIVERSAL BRAKE BLEEDER CAP ADAPTER

**HU11007**

- The universal solution to connect to the master cylinder reservoir for pressure bleeding with (for example) our HU11030 or HU11006
- Compact design with 90° quick coupler, will fit even when the reservoir is hard to reach
- Clamps on the threaded or 1/4 thread part of the reservoir (no chain under the reservoir)
- Adjustable height and width
- 4 interchangeable rubber cones to fit all sizes of reservoirs

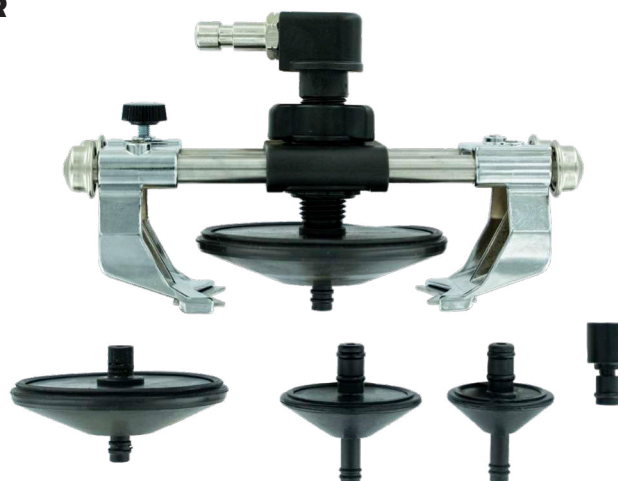



**NEW**

## ELECTRONIC BRAKE PRO BLEEDER

HU11030

HU11035

### VERSATILE. RELIABLE. EASY TO USE. THE BRAKE BLEEDER FOR EVERY WORKSHOP!

- Digital pulse pressure adjustment from 0.5 to 4.5 bar (7.25 to 65 psi)
- Automatic levelling of the master cylinder reservoir at the end of bleeding
- LCD colour display with 6 selectable languages (EN, FR, DE, IT, NL, ES)
- Automatic shut-off if :
  - wrong pressure is detected
  - There is a leak in the braking system
  - The new DOT drum or can is empty
- Flush mode allowing the use of another fluid (DOT)
- Heavy duty design for intensive use
- Powered by the vehicle's 12V battery
- Optional: power supply via auxiliary 12V battery or 110-230V AC to 12V DC transformer (HU11038).
- Cable and hose length: 5 m
- Supplied with European master cylinder cap, waste fluid collection bottle and rubber cone for drum and canister

**PATENTED**

**MADE IN BELGIUM**



**SCAN & WATCH  
ON YOUTUBE**

#### OPTIONAL: 230V TO 12V DC POWER SUPPLY (HU11038)



#### NEW: Power supply via 12V power tool battery (HU11030-9)



(Battery not included)

**20L**



HU11030

**60L**



HU11035

#### 2 CONFIGURATIONS:

**HU11030:** Portable version up to 20 L  
**HU11035:** On trolley version up to 60 L

Also available :

**HU11036:** Trolley only  
(to upgrade the portable version to on trolley version)

**NEW** **UNIVERSAL PRESSURE TESTER 2.0**

**PATENTED**

- Replaces all old analog testers with a single high-precision digital device.
- Thanks to its touchscreen tablet and Bluetooth module, it ensures reliable and fast measurements — both pneumatic and hydraulic.
- Allows comparison between the physical values measured in the circuit and those read by diagnostic tools.

**Tablet**

- Wi-Fi connection for automatic test result uploads (traceability and warranty proof) and automatic software updates
- Bluetooth connection with the wireless module
- Wired connection: pressure sensors can also be connected directly to the tablet
- Touchscreen with intuitive, icon-based interface
- USB-C port for fast charging
- Dual reading: possibility to connect two pressure sensors simultaneously
- Light and dark display modes for optimal comfort

**Bluetooth Module**

- Compact and perfect for road tests
- Mounts under the hood and communicates directly with the tablet in the vehicle via Bluetooth
- Up to two pressure sensors connected simultaneously
- Built-in lithium-ion battery with real-time charge status displayed on the tablet



All your test results accessible online from any device!  
Guaranteed traceability



**SCAN & WATCH  
ON YOUTUBE**



**BLUETOOTH MODULE  
FOR PRESSURE TESTER 2.0**  
(INCLUDED IN KIT HU35060)

**HU35055-2**





## UNIVERSAL PRESSURE TESTER 2.0

**HU35050**

- Wired connection



## UNIVERSAL PRESSURE TESTER 2.0 WITH WIRELESS MODULE

**HU35060**

- Bluetooth or wired connection



### Both kits include:

- 7" touchscreen tablet with lithium-ion battery
- -1 to 3 bar probe
- 0 to 300 bar probe
- Universal compression adapter for petrol engines
- Universal compression adapter for diesel engines
- 9x "T" adapters with SAE connectors (e.g. fuel pressure)

**NEW**

### 0-20 BAR SENSOR

**HU35050-3**

- Ideal for compression measurements on petrol engines (e.g. PureTech, Ecoboost, TFSI, etc.)



### Example of a fuel pressure test

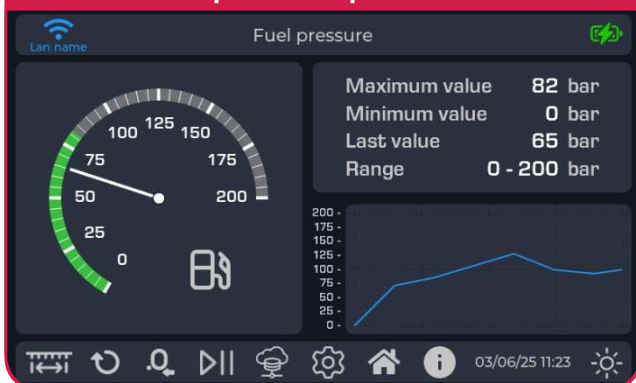

### Example of a compression test





### CYLINDER LEAKAGE TESTER

**HU35027**

- Can be used with the HU35025 PressureDiag OR with the included analogic gauge
- Gasoline adapters included : M10, M12 et M14
- Can be used with the diesel adapters from the PressureDiag range



### ENGINE AND TURBO OIL PRESSURE ADAPTERS (15 PCS)

**HU35033**

- 10 Common size adapters
- 4 Turbo Banjo adapters
- 1 Short 90° adapter



### GASOLINE HIGH PRESSURE ADAPTER SET (5 PCS)

**HU35029**

For GDI high fuel pressure engines



### UNIVERSAL TURBO PRESSURE ADAPTER SET

**HU35042**

Can be connected in place of the MAF sensor to any turbo boost pressure gauge or to the pressure tester (HU35050–HU35060)

**PATENTED**



### UNIVERSAL T ADAPTERS

**HU35041**

**SCAN & WATCH  
ON YOUTUBE**



### AIR CONDITIONING ADAPTER SET

**HU35038**

- 2 High pressure connectors
- 2 Low pressure connectors



### FUEL LINE SWIVELING QUICK DISCONNECT TOOL

**HU35019**

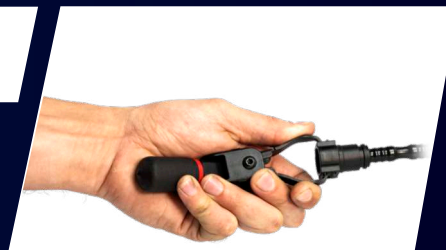





## COMMON RAIL INJECTOR CAP SET M12 & M14

**HU35030**



## COMMON RAIL DUMMY REGULATOR SET

**HU35031**



## DIESEL HIGH PRESSURE SET

**HU35026**

Measure the common rail pressure (M12x150)



## 90° COMMON RAIL ADAPTER SET (6 PCS)

**HU35028**

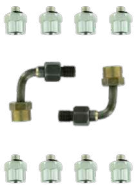

## BMW DIESEL ADAPTER SET M15 X100

**HU35032**

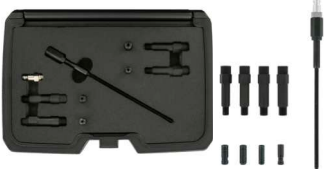

## UNIVERSAL DIESEL GLOW PLUG COMPRESSION ADAPTER

**HU35039**

M8x1, M9x1, M10x1 & M10x1.25

**PATENTED**



## UNIVERSAL DIESEL COMPRESSION ADAPTER

**HU35037**

Can be used with any analogic compression tester

**NEW**

## RECHARGEABLE DIGITAL WIRELESS STETHOSCOPE

**STE97605**

- **NOISE DETECTION** - Detect the source or squeaks, rattles, and other errant or troublesome noises throughout a car or truck's chassis
- **LCD TOUCHSCREEN** - 4.3-inch color LCD touch sensitive screen with easy to use interface.
- **RECHARGEABLE** - Control unit and transmitters feature internal rechargeable batteries



## WIRELESS ELECTRONIC STETHOSCOPE

**STE97216**

- **NOISE DETECTION** - Detect the source or squeaks, rattles, and other errant or troublesome noises throughout a car or truck's chassis

**SCAN & WATCH  
ON YOUTUBE**

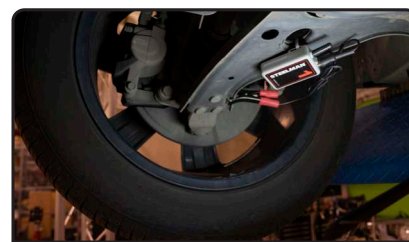
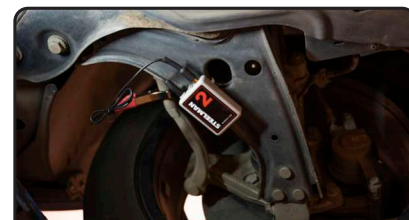

## RECORDING CABLE

**HU97001**

- **RECORD** your test on any IOS or Android device and **SHARE** them **EASILY**.
- Compatible with STE97605 and STE97216



## ULTRASONIC STETHOSCOPE

**HU33003**

- High-sensitivity leak detector

**Ideal for inspection and checking of :**

- Vacuum and air leaks
- Air conditioning leaks
- Electrical systems (insulation faults, sparks, relays...)
- LPG systems
- Tire leaks
- Passenger compartment sealing





**NEW**

## ARTICULATED VIDEOSCOPE 2 WAYS - Ø 3.9 MM

HU23157

### The high-end automotive diagnostic videoscope

- 3.9mm diameter camera
- 2-way articulated 1-meter probe (1280 x 720 px)
- 6 integrated LEDs – 3 adjustable levels of brightness
- 4.5" IPS HD display – 480 x 854 px
- Rechargeable 3.7V-5.000mAh Li-ion Battery
- Focal distance: 20-50mm
- Camera view angle: 80°
- Temperature displayed on screen
- Image rotation function
- Photo & video storage function
- IP67 rated camera
- Included accessories: 5V-2A charging plug, USB to USB-C cable & 32GB memory card



1 m cable

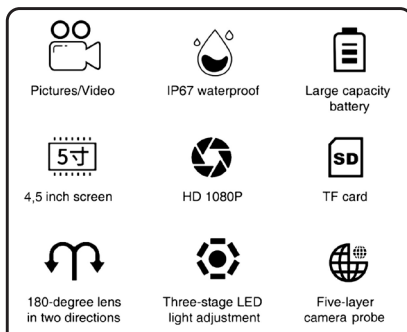

**NEW**

## VIDEOSCOPE DUAL LENS Ø 3.9 MM

HU23153

### Compact, precise, and durable

- Dual HD camera for front and side views
- Waterproof probe for gasoline, diesel, or oil inspections
- 5" HD IPS color display with tempered glass for optimal visibility
- Adjustable LED lighting on each lens for even visibility in hard-to-reach areas
- Rechargeable lithium battery via USB-C for extended on-site operation



1 m cable

## LEAK DETECTION SMOKE MACHINE

**HU12020**

**Detect leaks quickly and efficiently**

- Precise inspection of closed circuits: cooling systems, fuel (EVAP), exhausts, turbos, and sealed compartments (e.g., engine blocks)
- Complete kit included: oil bottle for smoke generation, accessories, and universal inflatable adapter
- Built-in air compressor: 1.3 bar for autonomous and efficient operation (integrated pump)



**SCAN & WATCH  
ON YOUTUBE**



## MITYVAC METAL VACUUM & PRESSURE PUMP

**MI8550**

**The original and essential manual pump!**

- Versatile: accurately generates and measures both vacuum and pressure
- More powerful than all its competitors in both pressure and vacuum
- Maximum performance: from -900 mbar to 4 bar
- Easy to use: ergonomic handle for easy and safe handling
- Durability: robust metal construction for long service life





**NEW**

## METAL TRAP

HU35043

### Metal Particle Detection Tool for Diesel Circuits

This tool is used in workshops to detect the presence of metal particles in the diesel fuel supply circuit, particularly at the outlet of the high-pressure pump. These particles are usually an early sign of high-pressure pump deterioration, a problem often identified too late, after several injector replacements.

#### Applications :

- When an injector shows signs of malfunction (clogged or defective).
- To check for the presence of metal debris in the low-pressure circuit and thus prevent repeated injector replacements.

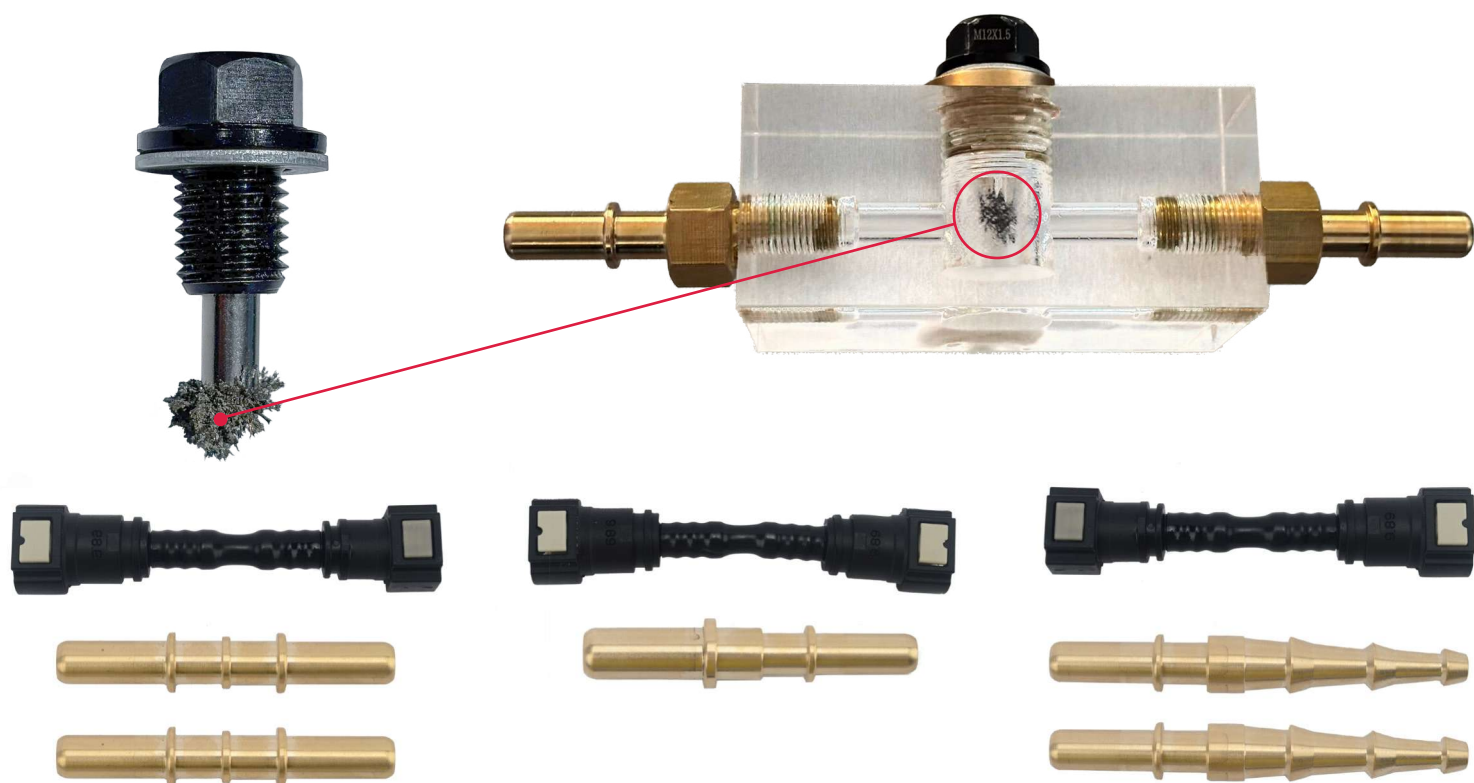



## SENSOR SIMULATOR

**HU31035**

- The ideal tool to simulate sensors and activate actuators: frequency, voltage and test sequences.
- It will assist in diagnostics when analysis with the OBD2 diagnostic tool reaches its limits.
- Sensors, injectors, and actuators notify the OBD2 tool that there is a problem, but the sensor simulator allows the technician to determine whether the malfunction is due to a faulty sensor, an issue in the vehicle's ECU, or a wiring fault.



**SCAN & WATCH  
ON YOUTUBE**



RESISTANCE • VOLTAGE • WAVE SINUS • SQUARE SINUS • TEMP COEFFICIENT SENSOR • THROTTLE & PEDAL SENSOR • OXYGEN LAMBDA SENSOR TEST (O2) • EXHAUST GAS PRESSURE SENSOR (EGR) • COMMON RAIL PRESSURE SENSOR • CAMSHAFT POSITION SENSOR (CMP) • CRANKSHAFT POSITION SENSOR (CKP) • KNOCK SENSOR • MAP SENSOR • ABS SENSOR • MAF SENSOR • HVAC PRESSURE SENSOR

**NEW**

## AIRBAG SIMULATOR RESISTOR RESET KIT

**HU31026**



**1.8 Ohm**



**2.2 Ohm**



**2.5 Ohm**



**2.7 Ohm**



**3.3 Ohm**

- Essential for precise SRS system diagnostics, this kit allows simulating an airbag's resistance to determine whether the fault actually comes from the airbag or another component (wiring, electronic control unit, etc.).
- Before any costly replacement, it helps accurately pinpoint the source of the problem.
- After an accident, these simulators also allow checking the integrity of the wiring without risking damage to a new airbag.
- A simple and effective tool to avoid unnecessary repairs and quickly identify the faulty component.



**NEW**

## AUTOMATIC RETRACTION CABLE

**HU31029**

- No more tangles with the banana cables!
- Save time and create a cleaner work environment with the 1-meter automatic retraction system.
- Each end has male and female connection to allow for multiple connections





## DIAGNOSTIC TEST LEAD SET (122 PCS) INCLUDES NEW ADDITIONAL Y-CONNECTORS

**HU31022**

- Complete lead kit for automotive diagnostics.
- Y-connectors for in-series test
- Ultra-thin tips, ideal for multi-pin connectors
- Includes a comprehensive set of connection leads for sensors, valves, connectors, injectors,...
- All leads are arranged properly in pairs "Male & Female" and by terminal sizes.
- Includes ATC, Mini and Maxi fuse adapters and ATC Current loop to be used with an Amp Clamp.

**OTHER PRODUCTS  
ON THE MARKET**



**HUBITOOLS:  
EXTRA THIN  
TEST LEAD**

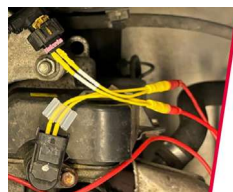

## 6 PCS NEEDLE TEST PROBE SET

**HU31021**

**High quality double insulated silicone test leads**

Set includes:

- 2 x Cable piercing
- 2 x 90° needles
- 2 x 90° banana cables

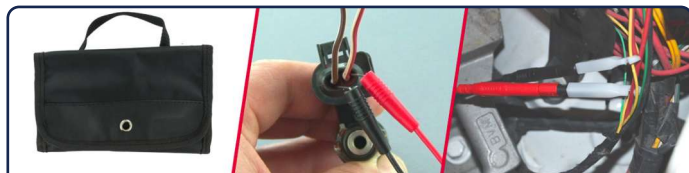

**NEW**

## 15PCS Y-LEAD SET

**HU31028**

The Y-leads enable maintaining a closed electrical circuit while reading the live signal

INSULATION CAP

FEMALE

MALE

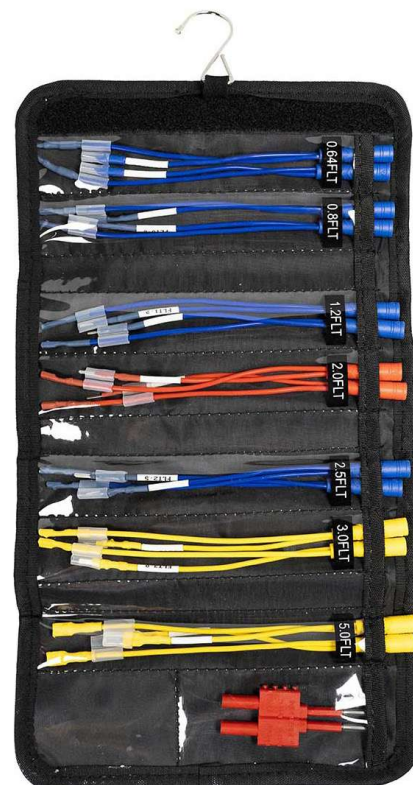
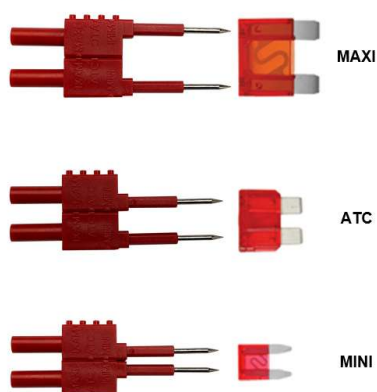

**PATENTED**

**NEW** HYBRID & EV TEST LEAD KIT

HU31045

Connection cable kit specially designed for electric and hybrid vehicles.

This kit stands out for its ability to adapt to the standardized copper contacts inside various connectors — regardless of their different external shapes.

Greatly facilitates measurements even when wearing gloves, thanks to its specially designed connectors!

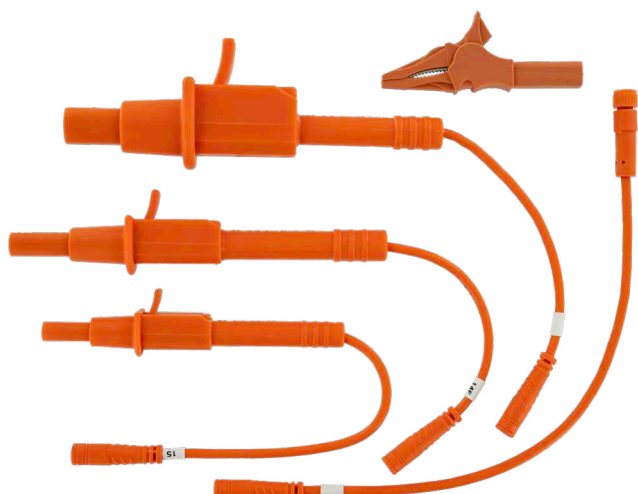

**COMING SOON**  
APRIL 2026

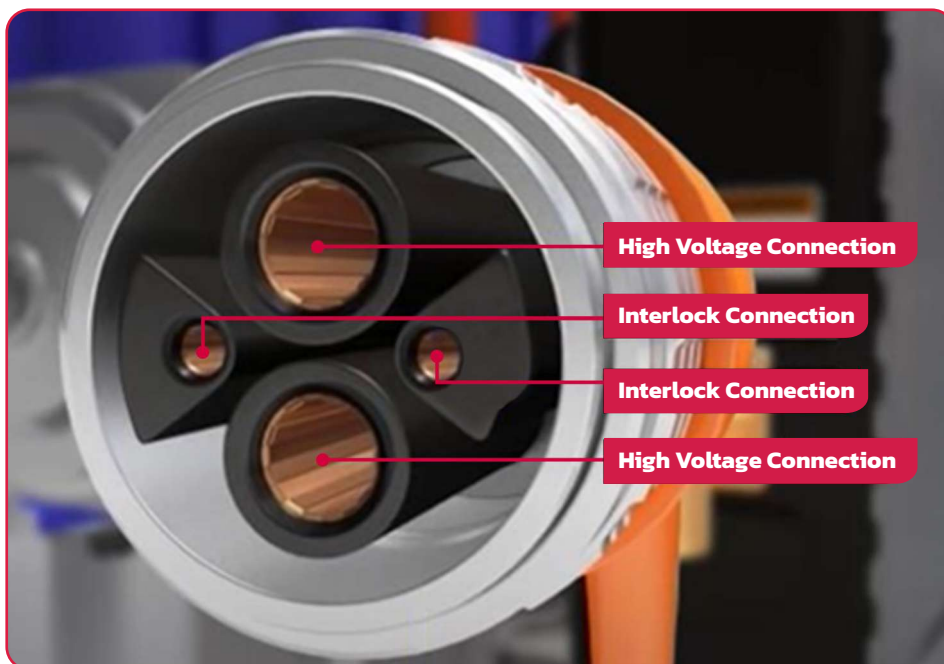



## This kit is used to check:

- The absence of voltage in locked-out vehicles
- The continuity of connectors, cables, or harnesses
- The insulation of the vehicle's various components

## Compatible with:

- Voltage Absence Tester (VAT)
- Multimeter
- Megohmmeter (Insulation Tester)

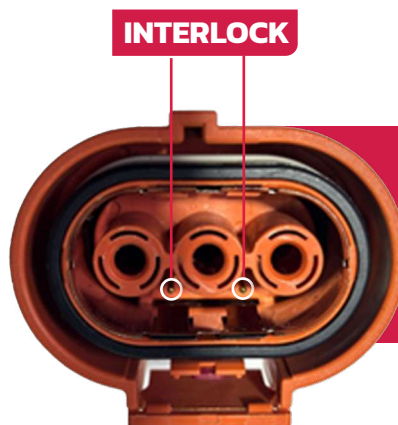

**Safety: CAT III 1000 V / CAT IV 600V**

- Standards: CE, UKCA
- Load limit: 12 A
- NF EN IEC 62196-2
- Connection: 4 mm banana plug

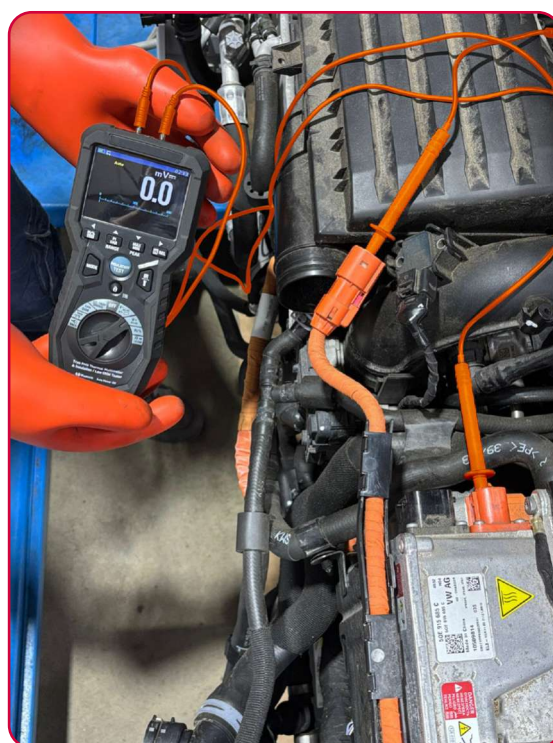
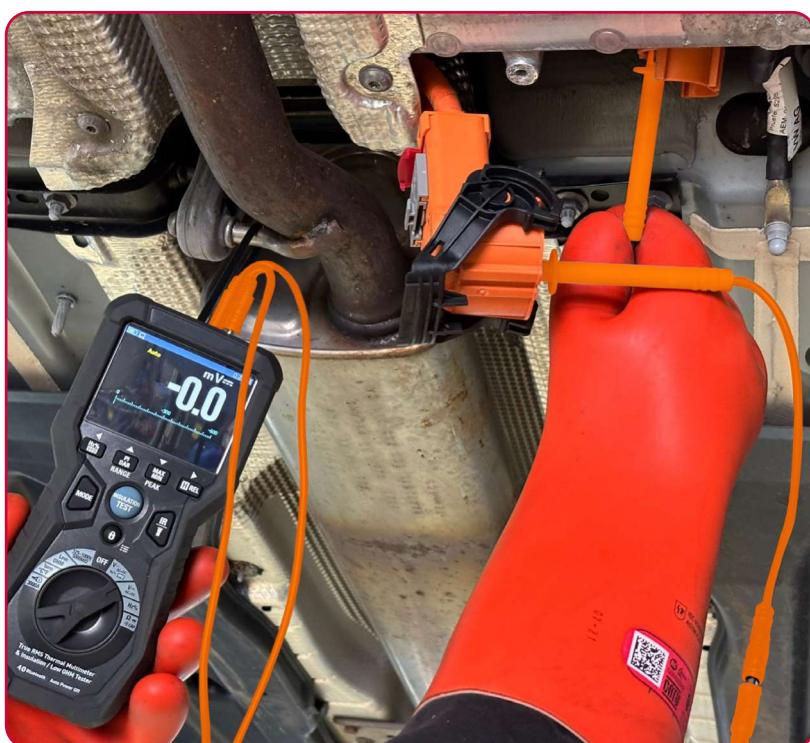



**PATENTED**

**UNIVERSAL DIESEL GLOW PLUG PULLER**  
M8, M10 X 1.00, M10 X 1.25

HU41051

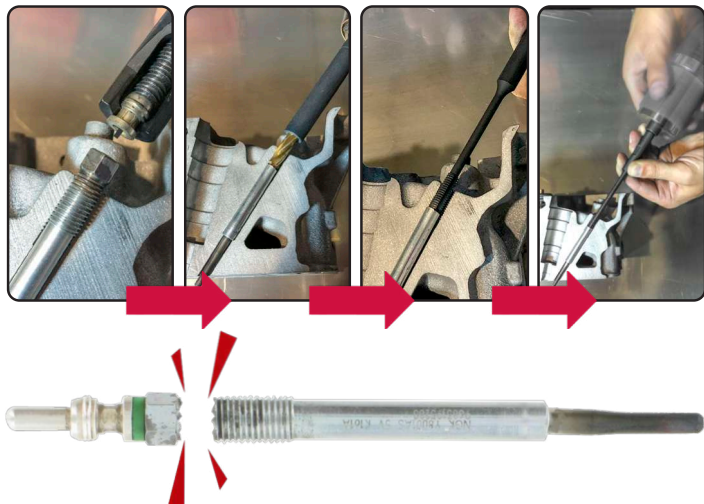

**SPECIAL CENTERED MILLS**

Self-centering industrial cutters



**SCAN & WATCH**  
**ON YOUTUBE**



**GLOW PLUG THREAD REPAIR SET**

M8, M9, M10 X 1.00, M10 X 1.25

HU41058

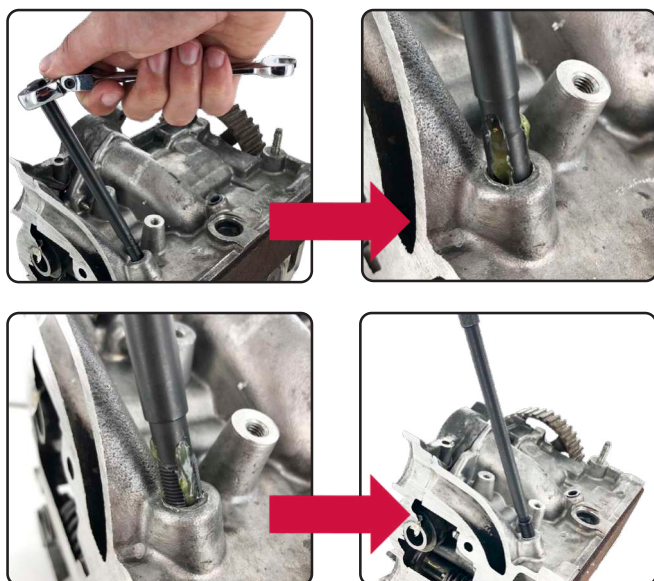

**SCAN & WATCH**  
**ON YOUTUBE**



Inserts available separately





## PATENTED

### UNIVERSAL GLOW PLUG TIPS PULLER M8, M9 & M10

**HU41050**

- Easy to use in hard-to-reach places
- Enables broken glow plug tips stuck in the cylinder head to be easily removed
- The kit Includes 4 different guides
- The tap, drill bit and extractor holders reproduce the shape of original glow plug for perfect centering and avoid any damage in the cylinder head
- Self-centering industrial taps
- The size of the drill bits and the shape of the holder prevents any risk of drilling or tapping too far into the cylinder head
- In the event of the tips being flared in the cylinder head, the kit has an ejector that enables the tip to be pushed back into the cylinder before retrieving it with the appropriate magnet included in the kit
- Easy 4-step operation



**SELF-CENTERING TAP**



**STOP BLOCK**  
→ NO MEASURING NEEDED

**1 = M8 x 1.00**  
**2 = M9 x 1.00**

**3 = M10 x 1.00**  
**4 = M10 x 1.25**

**SCANNEZ  
& REGARDEZ  
SUR YOUTUBE**



## REMOVES BROKEN TIPS

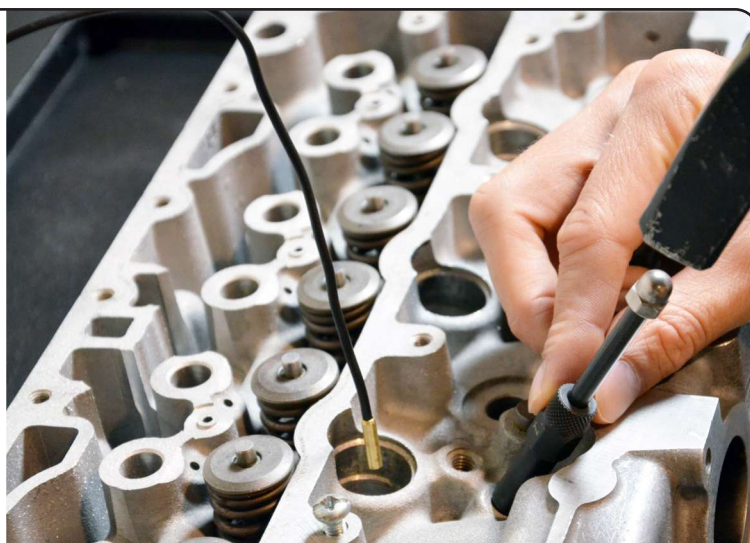
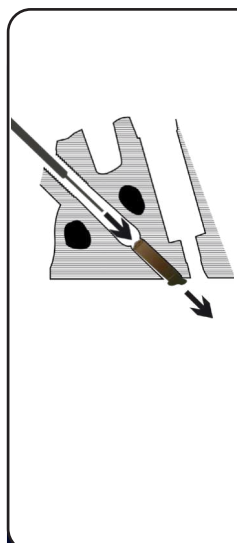

**PUNCH FOR FLARED TIPS**



## PATENTED

### UNIVERSAL INJECTOR PULLER

**HU41055**

- Eliminates the need to remove the electrical part of the injector
- Two ways of extracting the injector:
  - by rotating (handle)
  - by rotating AND slide hammering

**DENSO, BOSCH, DELPHI, SIEMENS**

**INJECTORES COMMON RAIL & PIEZO**

**COMPATIBLE CARS 1999 > TODAY**



**OPTIONAL SPECIAL  
ADAPTER FOR FORD ENGINES**

**HU41055-6**

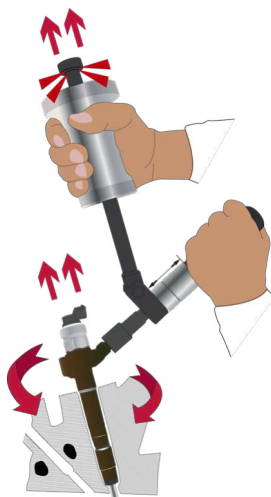

**NEW**

### LOW PROFILE PNEUMATIC DIESEL INJECTOR PULLER WITH HANDLE

**HU41056**

A powerful, fast, and compact tool for extracting even the most stubborn injectors, even in the tightest engine compartments.

#### Key features :

- Dual function: combines the power of a hammer with the speed of a pneumatic tool for maximum efficiency
- Compact design: on average 47 mm shorter than competing products, easily fits even in restricted access behind the firewall.
- Includes handle: makes positioning and removing the tool easier.
- Can be used without handle in very tight areas.

#### Adjustable impact mode :

- Hammer mode:  
Long stroke for maximum force.
- Fast vibration mode:  
Shorter stroke for vibration effect.

#### Included in the kit :

- Threaded adapters M14, M17, M20, M25, and M27
- Compatible with most diesel injectors: Denso, Siemens, Delphi, Bosch (internal thread).



**SCAN & WATCH  
ON YOUTUBE**

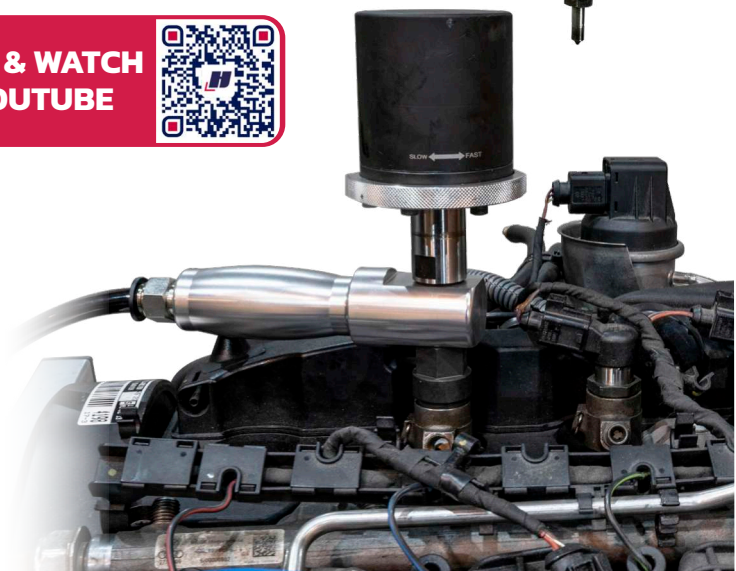
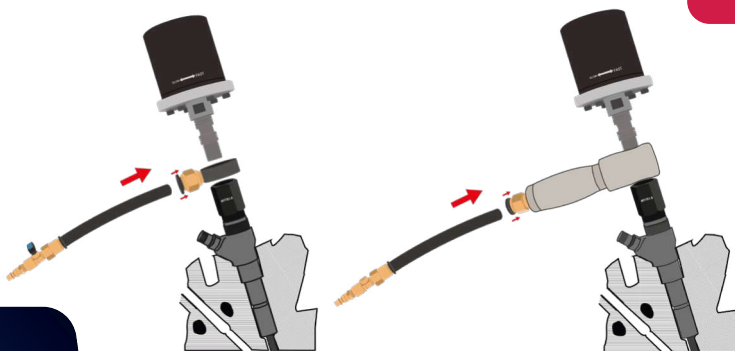



**PATENTED**
**DIESEL INJECTOR SEAL EXTRACTOR**
**HU41010**

- Supplied with 2 pullers: for passenger cars and commercial vehicles

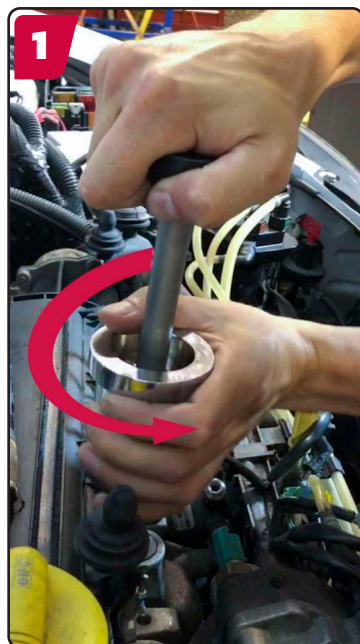
**SCAN & WATCH  
ON YOUTUBE**

**UNIVERSAL INJECTOR SEAT CLEANING SET**
**HU41039**

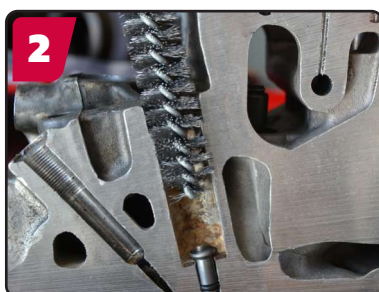
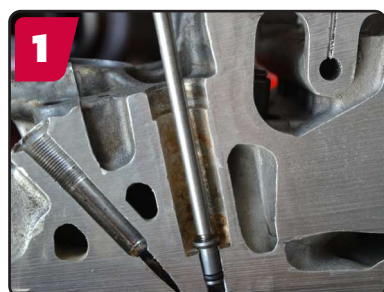
- This kit allows for a clean and gentle cleaning before installing the new injector.

**SCAN & WATCH  
ON YOUTUBE**



**PATENTED**

**Lugdriller**  
HUBITOOLS DESIGN

## LOCKING LUG NUT REMOVAL SET

**HU42025**

**The universal solution when the original key is lost or when the locking wheel nut is damaged by an impact wrench.**

The Lugdriller® is the universal tool to remove the most difficult locking lug nuts in the quickest and safest way.

- Compatible with all types of anti-theft wheel nuts, regardless of brand or shape.
- Also effective on damaged lug nuts.

### Set includes :

- 4 internal nylon centering sleeves
- 3 external metal centering caps
- 1 metal centering sleeve for Volvo
- 2 special ultra-hard drills
- 4 impact extractors
- 1 holder for impact extractor
- 1 removal tool for impact extractor



**SCAN & WATCH  
ON YOUTUBE**



**EXAMPLE:**  
With the new  
Stellantis locking  
wheel nut



**NEW**

## FULL CARBIDE TURBODRILL

**HU42026**

Enables quicker drilling  
with the HU42025 Lugdriller





## PATENTED

### ARTICULATED MCPHERSON LIFTING TOOL (500 KG)

HU43025

- Ideal for the following operations:
  - Removal and installation of struts / McPherson
  - Removal and installation of drive shaft (CV joints)
  - Removal and installation of suspension arms and ball joints
- No risk of damage to parts such as sensors, wiring harness, plastic protection, body panels
- To be mounted on 25-30mm hydraulic transmission jacks
- Soft clamping jaws to avoid damage to the strut.
- 3 sizes of jaws:
  - light vehicle
  - light commercial vehicle (optional)
  - rear shock absorbers (optional)
- Horizontal adjustment and full articulation
- 100% safe operation (operator has both hands free to work safely)
- Compatible with EV & Hybrid cars

 <p><b>Max. 100kg</b></p> <p><b>Not articulated</b></p> <p><b>Not adjustable</b></p> <p><b>Unsafe</b></p> <p><b>BENDING OF THE TRANSMISSION JACK</b></p> <p><b>OTHERS</b></p>	 <p><b>500kg</b></p> <p><b>Articulated</b></p> <p><b>Adjustable</b></p> <p><b>Safe</b></p> <p><b>HUBITOOLS DESIGN</b></p>
--	---

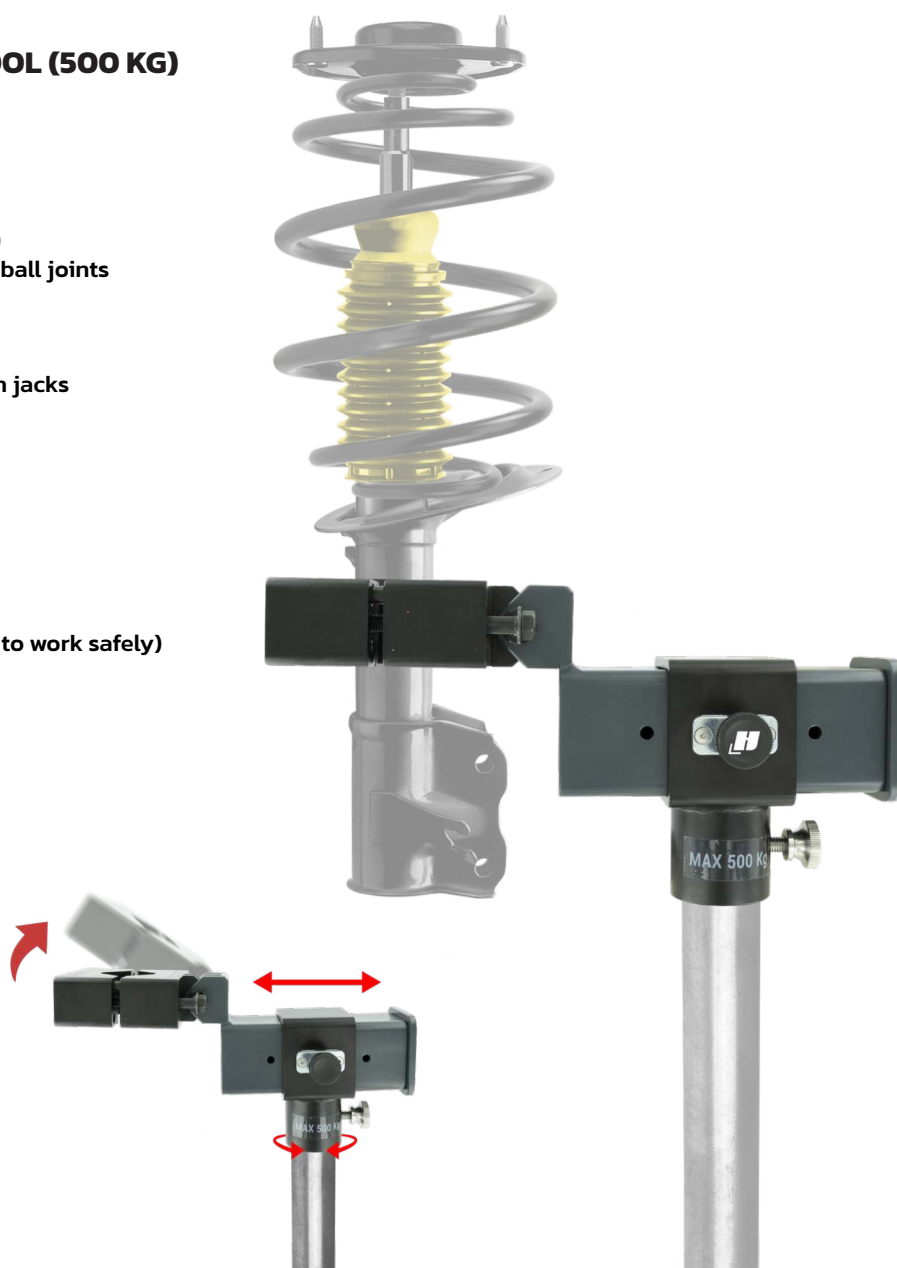

**ALSO WORKS ON EV & HYBRID CARS  
TO BE MOUNTED ON ANY TRANSMISSION JACK (25-30MM)**

**NEW**

### HUB SPREADER

HU43026

Designed to open and hold the wheel hub, facilitating the easy removal and refitting of the suspension strut.

**ULTRA-ROBUST**



**SCAN & WATCH  
ON YOUTUBE**



**NEW**

**DRIVE SHAFT DISASSEMBLY LEVER**

**HU43027**

- Its U-shaped design ensures equal force distribution on both sides of the drive shaft.
- The precisely machined beveled head makes it easy to insert the tool between the drive shaft and the gearbox, providing optimal leverage for removal.
- Facilitates the removal of drive shafts equipped with retaining clips (circlips).
- Thanks to its clever design, with a beveled head and support around the entire circumference of the drive shaft, this tool allows efficient removal without putting pressure on the gearbox, preventing any risk of damage.

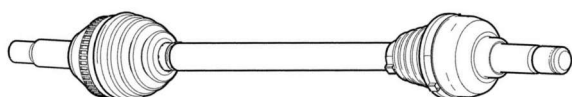

**SCAN & WATCH  
ON INSTAGRAM**



**IDEAL FOR DRIVESHAFTS WITH RETAINING CLIPS / CIRCLIPS**



60CM

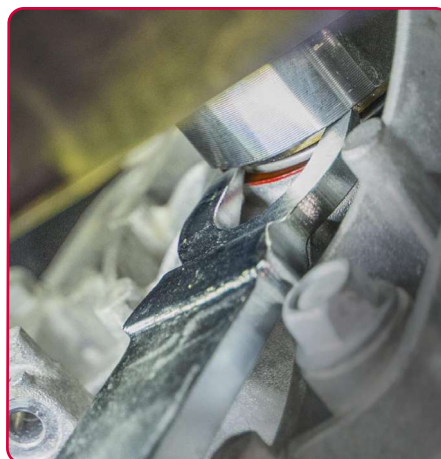
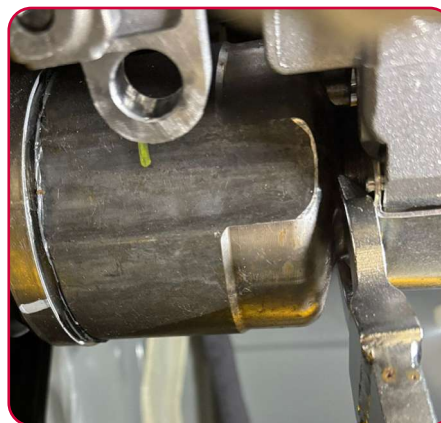
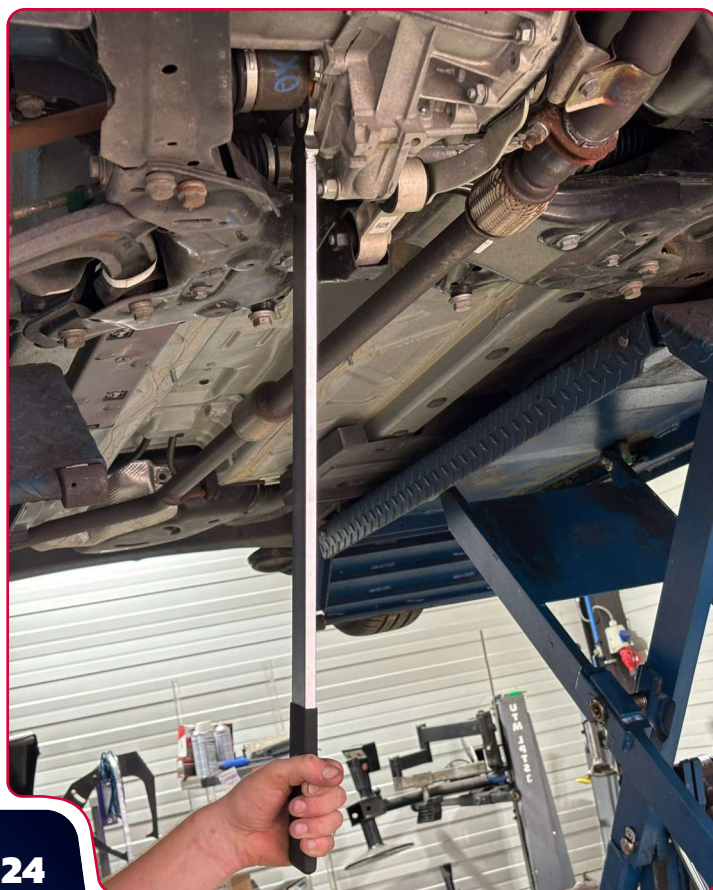



**NEW**

## MAGNETIC ADJUSTABLE TOOL HOLDER

HU51030

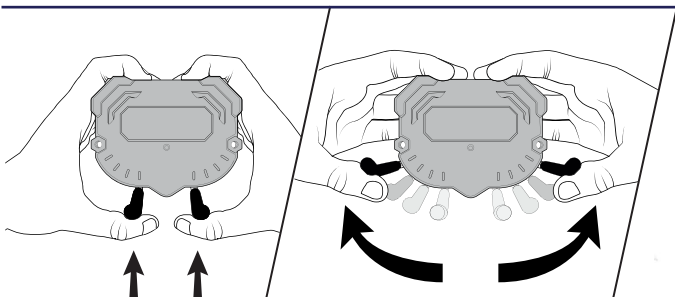

**NEW**

## MAGNETIC CAN CLIPS (5 PCS)

- Ideal for workshops or DIY
- Designed to conveniently store and transport cans between the toolbox and the workstation
- Equipped with strong magnets for secure attachment to metal surfaces



HU51020

Set of 5 clips (Ø 62 mm)

HU51021

Set of 5 clips (Ø 45 mm)



**SCAN & WATCH  
ON INSTAGRAM**



**NEW**

## LITHIUM PRO BOOSTER 12V – 2000A

**HU34040**

- 12 V
- LiFePO4 battery
- Max current: 2000 A
- Starting current: 1000 A
- Capacity: 59.2 Wh
- Dimensions: 133 x 120 x 260 mm

### Key features :

- Vertical design with integrated cables
- Storage space for clamps on the back
- Magnetic base
- Powerful LED lamp, white or red, on the front

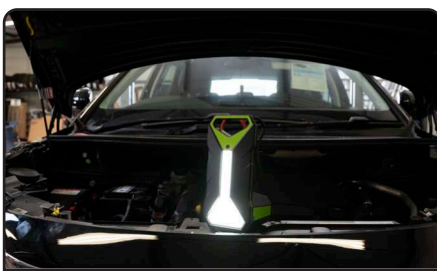

## LITHIUM BOOSTER 12V 1200A / 24V 600A

**HU34035**

- 12v & 24v
- LiFePO4 battery
- Peak current: 12v 1200A, 24v 600A
- Starting current: 12v 600A, 24v 300A
- Capacity 35,000mAh (102,4 Wh)
- Dimensions : 292 x 233 x 79mm

### Key features :

- Compatible with 12V and 24V vehicles
- High-capacity battery for long usage cycles before recharging
- Professional design with long cables
- Powerbank
- LED light





## START & STOP BATTERY TESTER WITH PRINTER

HU34012

SCAN & WATCH  
ON YOUTUBE



- Quick check of battery condition (6–12V) and charging circuits (12–24V)
- For batteries from 40 to 2000 CCA
- Battery types: EFB, VRLA / GEL, Flat Plate AGM and Spiral AGM & Standard wet batteries
- 6 languages (EN, FR, ES, DE, IT, PT)



## BATTERY TESTER & CHARGING SYSTEM ANALYSER WITH PRINTER

HU34039

- Large backlit display
- Standard-size printer paper
- Tests 12V batteries and 12V/24V charging systems
- Suitable for batteries from 40 to 2000 CCA
- Battery types: EFB, VRLA / GEL, AGM Flat Plate, AGM Spiral & standard wet batteries
- 3 functions: battery test, system test (alternator), and in-vehicle test (combination of battery and system test)
- 6 languages: EN, FR, ES, DE, IT, PT



## BLUETOOTH BATTERY TESTER + LIVE MONITORING

HU34045

### Key features :

- Free app to use on any Android or IOS device
- Battery test, battery charging system test
- Live voltage monitoring for BMS system test



SCAN & WATCH  
ON YOUTUBE



## BATTERY CHARGER/ MAINTAINER/ POWER SUPPLY 1.5/10AMP

HU34027

### Key features :

- Compatible with all battery types, including Li-Ion
- Intelligent charging process
- Ideal for powering vehicles in showrooms (showroom mode)



Start (A) Stop

**NEW**

## 2-IN-1 HOT AIR & HOT IRON PLASTIC REPAIR STATION

HU31040



**SCAN & WATCH  
ON YOUTUBE**

- Ultra-competitive price and fast return on investment
- Compact and ergonomic design
- Encourages repair rather than replacement
- Consumables kit included (ABS/PC, PP/PE, PS rods and metal mesh)

### Hot air welder

- Adjustment of air flow (3 L/min to 24 L/min) and temperature (100°C to 500°C)
- Designed for professional plastic rod welding
- Ultra-fast preheating
- Ensures strong welds and allows precise addition of plastic material required for repair
- Automatic hot air shut-off when the handle is placed back on its holder

### Airless iron welder

- Adjustable temperature (50°C to 480°C)
- Ready to use in less than 30 seconds
- Heating tip specially designed to melt plastic, apply mesh reinforcement, repair or replace a parking sensor mount, etc.

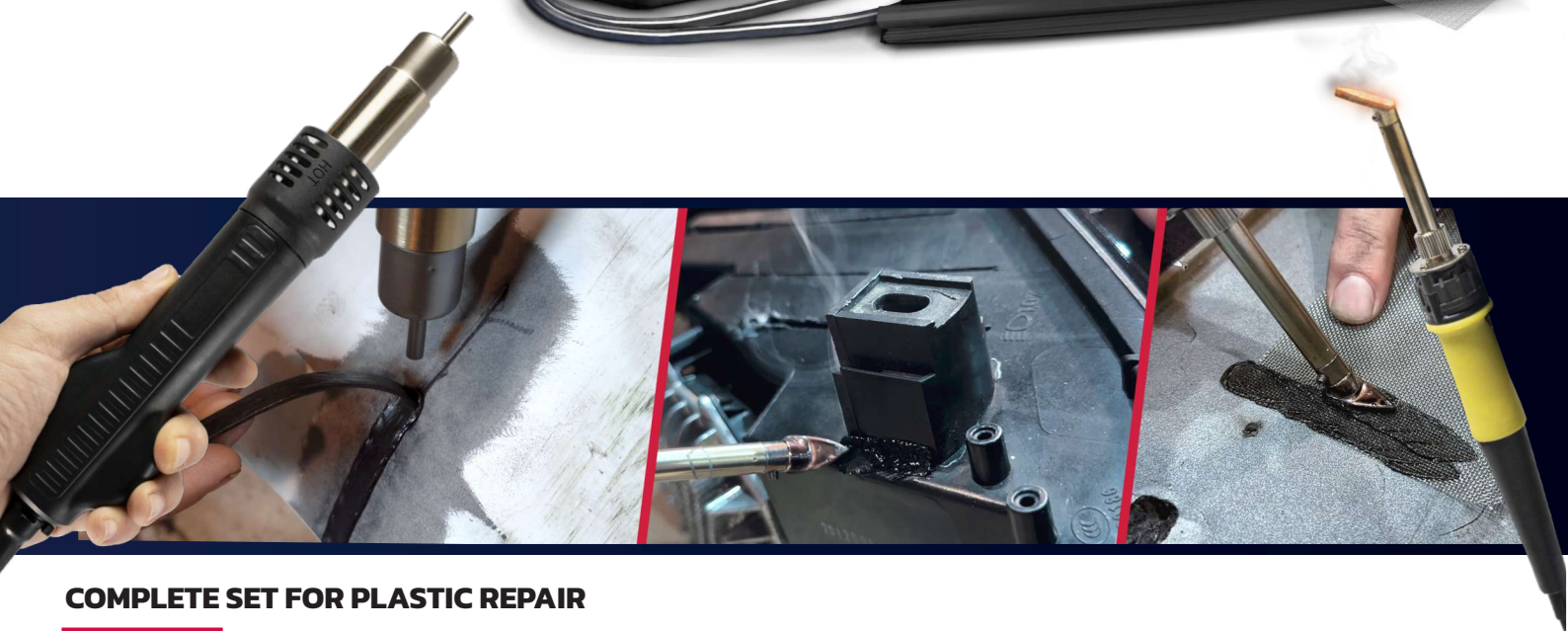

## COMPLETE SET FOR PLASTIC REPAIR

HU31031

- Cordless tool designed for efficient plastic repair.
- Battery-powered device with a 30W lithium battery, featuring a pen-style design for comfortable and precise handling.

### Includes 3 specific tips:

- Universal tip for quick and effective plastic melting.
- Plastic injection tip, ideal for using the supplied plastic rods for precise repairs.
- Staple tip, allowing the use of the supplied staples to secure plastic parts during repair.





**NEW**

## PARKING SENSOR INSTALLATION KIT

**HU31034**

- Ideal for professional installation of plastic brackets for parking aid sensors.

### The kit includes :

- 1 powerful cordless welding device with LED light
- 3 dedicated heads with end-stop to prevent damage to the front of the bumper
- 1 beveled heads



## AIR VACUUM DENT PULLER

**HU44016**

- Vacuum sliding hammer to pull dents without grinding or damaging the paint
- Can be used for PDR (paintless dent removal) but also prior to grinding the paint on a regular dent repair work
- Supplied with 3 different suction cups
- Operates using standard garage compressed air
- Sliding hammer's weight: 1,2kg, total weight: 4,7kg



## POCKET FLOODLIGHT 700LM

**HU21045**

- Swiveling compact LED floodlight with rechargeable Li-Ion battery
- Strong base magnet
- Super sturdy aluminum body
- 3 levels of brightness – 100 / 350 / 700 lumens
- Run time – 10hr / 4 hr / 2hr



**SCAN & WATCH  
ON YOUTUBE**

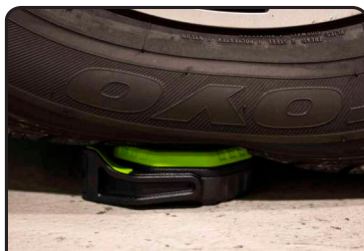
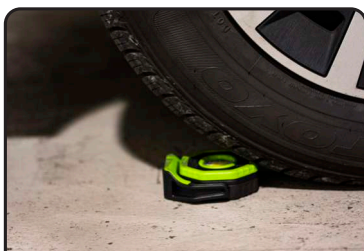

## 5 PIECE TRIM CLIP LIFTER SET

**HU44019**

- Ideal for plastic clip removal
- Sturdy and super slim design
- Will not bend like the plastic levers do





## NEW TURBO JET AIR BLOWERS

HU14021 **MINI BLOWER**

HU14022 **JUMBO BLOWER**

SCAN & WATCH  
ON YOUTUBE



### ONE TOOL. ENDLESS USES.

#### AUTOMOTIVE & DETAILING

- Quick-drying after car wash
- Drying after painting or coating
- Removes polish or compound dust

#### CLEANING & MAINTENANCE

- Dust removal from tools, vents, and filters
- Clears garages, workshops, and floors
- Dries surfaces after cleaning

#### INDUSTRIAL & WORKSHOP

- Dries equipment and machinery
- Clears shavings, sawdust, and particles
- Cools tools and materials

#### OUTDOOR USE

- Removes snow, fallen leaves, and debris
- Ideal for patios, driveways, and garden tools
- Starts BBQs or campfires

#### ACCESSORIES FOR THE HU14022

HU14022-2



**Boost Nozzle**



**Diffuser Nozzle**



**Extension Nozzle**



**Carry Case**

HU14022-5

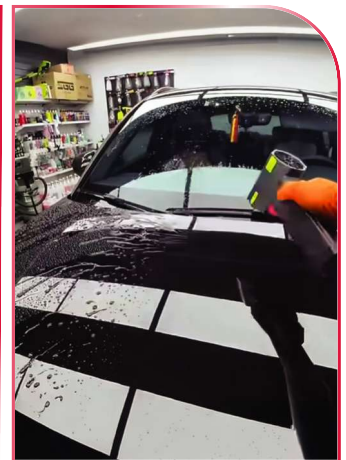



**NEW**

**SMART & MOBILE OIL BAR DISPENSER**

**HU46030**

**SCAN & WATCH  
ON YOUTUBE**



**FILL THE OIL JAR  
MANUALLY: ~5 MINUTES**



**AND ANOTHER 5-10 MINUTES  
TO TRANSFER TO THE VEHICLE**



**VS**

**SELECT OIL TYPE = 10 seconds  
INSERT HOSE INTO VEHICLE = 10 seconds  
JUST LET THE MACHINE FILL UP THE VEHICLE BY ITSELF!**

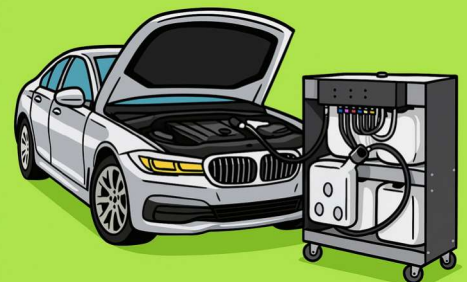



- The Smart & Mobile Oil Bar is a robust, autonomous dispensing unit designed to simplify and optimize fluid management in modern workshops.
- It supports all types of motor and gear oils, and can hold up to 6 x 20L or 6 x 30L containers.
- With an average-sized workshop (6 technicians), the return on investment is reached within 5 to 6 months, thanks to time saved per fill-up, reduced oil waste, and billing accuracy provided by the integrated software.

Efficient. Intelligent. European-Made.

- Battery powered (via a 12V power tool battery, e.g. Milwaukee)
- Equipped with a high-performance gear pump
- Adjustable flow speed helps avoid engine spillage and keeps work area clean

Time-saving & Cost-efficient

- Frees up technician time (avg. 5 minutes saved per fill-up)
- Integrated software reduces risk of using incorrect oil
- Precision dosing = reduced waste (garages lose ~7% of oil due to spills and overfilling)

Smart Connectivity & Traceability

- Full traceability: automatic emails can be sent after each fill with detailed information (operator name, oil type, quantity)
- Connected interface with secure operator login (ID + PIN)
- Possibility of automated reordering to suppliers when oil levels are low
- Improved stock management and error-free billing

Comfort & Ergonomics

- Ergonomic trolley design for easy mobility in the workshop
- Enables technicians to work closer to vehicles
- Reduces physical strain and risk of injury



	Traditional Method (Jug)	SMART & MOBILE OIL BAR DISPENSER
Efficiency	Manual process, time-consuming	Autonomous system, saves ~5 minutes per fill-up
Oil Waste	Frequent overfills and spills (avg. 7% loss)	Precise dosing, minimizes waste
Risk of Error	Higher risk of using wrong oil	Software reduces risk of incorrect oil usage
Cleanliness	Risk of spills on floor or engine bay	Controlled flow, avoids drips and keeps work area clean
Traceability	None	Automatic recording: operator, oil type, volume
Billing Accuracy	Errors and omissions are common	Automated, error-free billing
Stock Management	Manual, prone to delays and stockouts	Automatic reorder notifications to supplier
Mobility	Jug must be carried manually	Mobile, ergonomic trolley
Operator Ergonomics	Repetitive bending and lifting, injury risk	Work closer to vehicle, reduces physical strain

## 2-IN-1 HOT AIR & HOT IRON PLASTIC WELDING STATION

HU31040



SCAN ME

### DESIGNED TO WELD ALL VEHICLE PLASTIC PARTS:

- BUMPERS
- BODY PANELS
- HEADLIGHT BRACKETS
- FRONT MASKS



HOT AIR WELDER



AIRLESS IRON WELDER

## FOLLOW US

 [hubitools.com](https://www.hubitools.com)

 [hubitools.sa](https://www.instagram.com/hubitools.sa)

 [hubitools](https://www.facebook.com/hubitools)

 [hubitools](https://www.youtube.com/hubitools)